



## TERMINALES DE COMPRESIÓN CAÑA CORTA MELEC



### — Datos técnicos

- Material : Cu 99.9%
- Superficie : Electroestañado
- Aplicación : Bajo voltaje, para uso interno

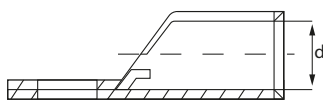
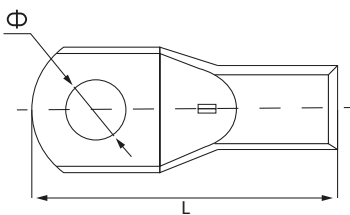

CÓDIGO	DESCRIPCIÓN DEL PRODUCTO	DIMENSIONES		
		L	d	O
09489	JM 2.5-5 14AWG 3/16" 20A	15	3.7	5
09375	JM 4-5 12AWG 3/16" 25A	20	3.7	5
09497	JM 6-5 10AWG 3/16" 30A	25	3.7	5.2
09498	JM 6-6 10AWG 1/4" 30A	25	3.7	6.5
09499	JM 6-8 10AWG 5/16" 30A	25	3.7	8.4
26970	JM 10-10 8AWG 3/8" 35A	28	4.5	10.3
09479	JM 10-5 8AWG 3/16" 35A	26	4.5	5.3
09480	JM 10-6 8AWG 1/4" 35A	25	4.5	6.5
09481	JM 10-8 8AWG 5/16" 35A	26	4.5	8.4
09483	JM 16-10 6AWG 3/8" 50A	31	5.7	10.3
09484	JM 16-5 6AWG 3/16" 50A	31	5.7	10.3
09363	JM 16-6 6AWG 1/4" 50A	28.5	5.7	6.5
09485	JM 16-8 6AWG 5/16" 50A	30.5	5.7	8.4
09490	JM 25-10 4AWG 3/8" 70A	35	7.2	10.5
09367	JM 25-6 4AWG 1/4" 70A	35	7.2	6.5
09368	JM 25-8 4AWG 5/16" 70A	35	7.2	8.4
18802	JM 25-12 4AWG 1/2" 70A	35	7.2	8.4
09370	JM 35-10 2AWG 3/8" 90A	39	8.5	10.5
09491	JM 35-12 2AWG 1/2" 90A	39	8.5	13
09371	JM 35-6 2AWG 1/4" 90A	37.5	8.5	6.5
09380	JM 35-8 2AWG 5/16" 90A	38	8.5	8.5
09493	JM 50-10 1/0AWG 3/8" 125A	45	9.8	10.5
09494	JM 50-12 1/0AWG 1/2" 125A	45	9.8	13
09505	JM 50-14 1/0AWG 9/16" 125A	45	9.8	14.5
09495	JM 50-8 1/0AWG 5/16" 125A	45	9.8	8.5
09379	JM 70-10 2/0AWG 3/8" 150A	51.5	11.5	10.5
14067	JM 70-12 2/0AWG 1/2" 150A	51.5	11.5	13
09381	JM 70-8 2/0AWG 5/16" 150A	50	11.5	8.5
09500	JM 95-10 4/0AWG 3/8" 175A	58.5	13.7	10.5
09501	JM 95-12 4/0AWG 1/2" 175A	58.5	13.7	13
09502	JM 95-8 4/0AWG 5/16" 175A	58.5	13.7	8.5
09358	JM 120-10 250MCM 3/8" 195A	63.5	15	10.5
09359	JM 120-12 250MCM 1/2" 195A	65	15	13
15545	JM 120-20 250MCM 3/4" 195A	70.5	15	21
09360	JM 150-10 300MCM 3/8" 215A	73	16.7	10.5
09482	JM 150-12 300MCM 1/2" 215A	73	16.7	13
09361	JM 150-14 300MCM 9/16" 215A	73	16.7	14.7
09362	JM 150-16 300MCM 5/8" 215A	73	16.7	17
09486	JM 185-10 400MCM 3/8" 260A	80	19.2	10.5
09364	JM 185-12 400MCM 1/2" 260A	80	19.2	13
09487	JM 185-14 400MCM 9/16" 260A	80	19.2	14.7
09488	JM 185-16 400MCM 5/8" 260A	80	19.2	17
18116	JM 240-12 500MCM 1/2" 280A	92.5	21	13
09365	JM 240-14 500MCM 9/16" 280A	92.5	21	14.7
09366	JM 240-16 500MCM 5/8" 280A	92.5	21	17
10908	JM 240-20 500MCM 3/4" 280A	94.5	21	21
09369	JM 300-16 600MCM 5/8" 320A	102	24	17
09373	JM 400-16 750MCM 5/8" 550A	114	27	17
09374	JM 400-20 750MCM 3/4" 550A	116	27	21
09492	JM 500-16 1000MCM 5/8" 650A	127	30	17
15546	JM 500-20 1000MCM 3/4" 650A	127	30	21
09378	JM 630-16 5/8" 650A	140	35	17
09496	JM 630-20 3/4" 650A	140	35	21

### CERTIFICACIONES:

